

Equal, Pulled & Reducing Tees

Full, Equal Tees

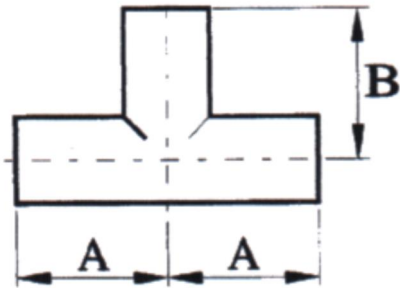

SIZE		DIM A	DIM B	Code
Inch	mm	mm	mm	
1"	25.4	44	44	P201-10
1 1/4"	31.8	64	64	P201-15
1 1/2"	38.1	54	54	P201-12
2"	50.8	89	89	P201-20
2 1/2"	63.5	114	114	P201-25
3"	76.2	134	134	P201-30
4"	101.6	174	174	P201-40

Pulled Tees

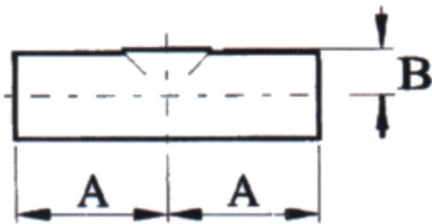

SIZE		DIM A	DIM B	Code
Inch	mm	mm	mm	
1	25.4	44	14	P203-10
1 1/2	38.1	64	22	P203-15
2	50.8	89	29	P203-20
2 1/2	63.5	114	35	P203-25
3	76.2	134	41	P203-30
4	101.6	174	51	P203-40
6	154	143	83	P202-60

Equal, Pulled & Reducing Tees

Reducing Tees

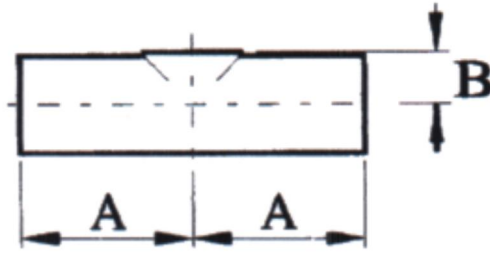

SIZE		DIM A	DIM B	Code
Inch	mm	mm	mm	
1 x 0.5	25.4 x 12.7	50	14	P209-05
1 x 0.75	25.4 x 19.05	50	14	P209-075
1.5 x 0.5	38.1 x 12.7	64	22	P209-10B
1.5 x 0.75	38.1 x 19.05	64	22	P209-10A
1.5 x 1	38.1 x 25.4	64	22	P209-10
2 x 0.5	50.8 x 12.7	89	28	P210-050
2 x 0.75	50.8 x 19.05	89	28	P210-075
2 x 1	50.8 x 25.4	89	28	P210-10
2 x 1.5	50.8 x 38.1	89	29	P210-15
2.5 x 0.5	63.5 x 12.7	114	35	P211-050
2.5 x 0.75	63.5 x 19.05	114	35	P211-075
2.5 x 1	63.5 x 25.4	114	35	P211-10
2.5 x 1.5	63.5 x 38.1	114	35	P211-15
2.5 X 2	63.5 x 50.8	114	35	P211-20
3 x 0.5	76.2 x 12.7	134	41	P212-050
3 x 0.75	76.2 x 19.05	134	41	P212-075
3 X 1	76.2 x 25.4	134	41	P212-10
3 X 1.5	76.2 x 38.1	134	41	P212-15
3 X 2	76.2 x 50.8	134	41	P212-20
3 X 2.5	76.2 x 63.5	134	41	P212-25
4 x 0.5	101.6 x 12.7	174	54	P213-050
4 x 0.75	101.6 x 19.05	174	54	P213-075
4 X 1	101.6 x 25.4	174	54	P213-10
4 X 1.5	101.6 x 38.1	174	54	P213-15
4 X 2	101.6 x 50.8	174	56	P213-20
4 X 2.5	101.6 x 63.5	174	56	P213-25
4 X 3	101.6 x 76.2	174	56	P213-30
6 X 3	154 x 76.2	150	126	P214-30
6 x 4	154 x 101.6	150	126	P214-40