

Flanges—Mild Steel Zinc Plated PN16 Backing Ring

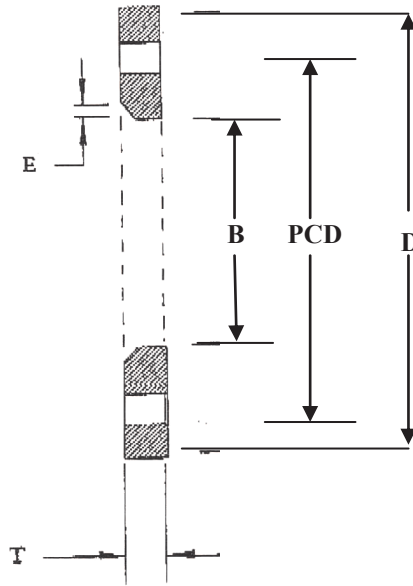

| SIZE | Number of Holes | Hole Size | D | B | PCD | E | T | Weight Kg |
|------|-----------------|-----------|-----|------|-----|---|----|-----------|
| 25 | 4 | 14 | 115 | 35 | 85 | 3 | 10 | 0.70 |
| 32 | 4 | 18 | 140 | 44.5 | 100 | 3 | 10 | 1.00 |
| 40 | 4 | 18 | 150 | 52 | 110 | 3 | 10 | 1.15 |
| 50 | 4 | 18 | 165 | 63 | 125 | 3 | 10 | 1.35 |
| 65 | 4 | 18 | 185 | 77 | 145 | 3 | 10 | 1.70 |
| 80 | 8 | 18 | 200 | 93 | 160 | 3 | 10 | 1.80 |
| 100 | 8 | 18 | 220 | 119 | 180 | 4 | 10 | 1.95 |
| 125 | 8 | 18 | 250 | 145 | 210 | 4 | 12 | 2.90 |
| 150 | 8 | 22 | 285 | 173 | 240 | 5 | 12 | 3.50 |
| 200 | 12 | 22 | 340 | 225 | 295 | 6 | 12 | 4.40 |
| 250 | 12 | 26 | 405 | 279 | 355 | 6 | 16 | 7.70 |
| 300 | 12 | 26 | 460 | 329 | 410 | 6 | 19 | 11.20 |
| 350 | 10 | 26 | 520 | 362 | 470 | 8 | 22 | 18.30 |
| 400 | 16 | 30 | 580 | 413 | 525 | 8 | 22 | 22.10 |